



Stonegate

20" COLUMN PLANTER INSTALLATION INSTRUCTIONS

KEYSTONE®
Country Manor

KEYSTONE BUILDING IDEAS • 20" COLUMN PLANTER

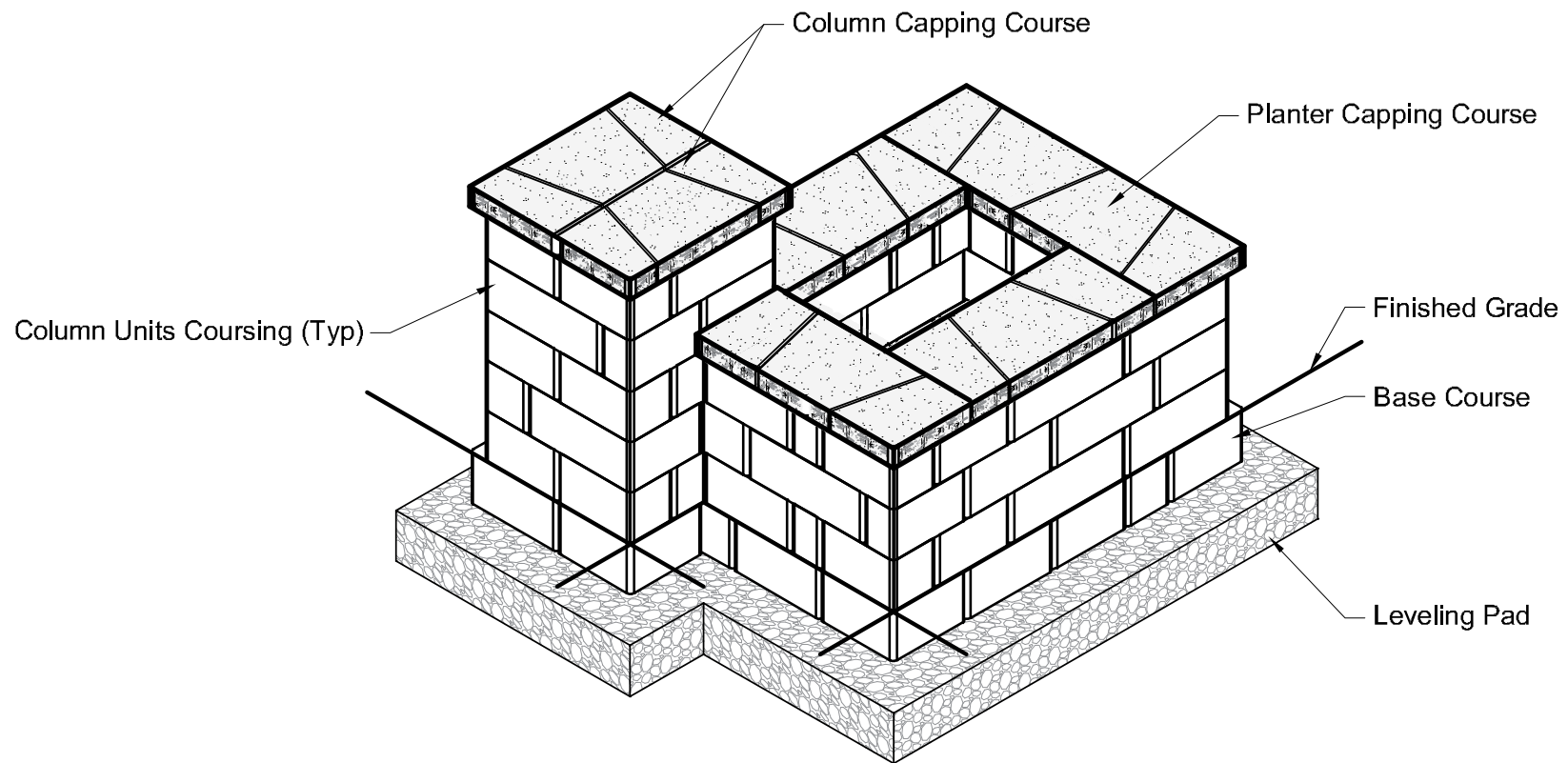

This planter detail can be built using either Stonegate® Country Manor® or Country Manor®, depending on the aesthetic look you want to achieve.

You will need: 23 Large, 22 Medium, and 23 Small units, plus 13 capping units for the planter and 4 capping units for the column. Exterior grade concrete adhesive required to adhere each course and caps.

COURSE BY COURSE INSTRUCTIONS

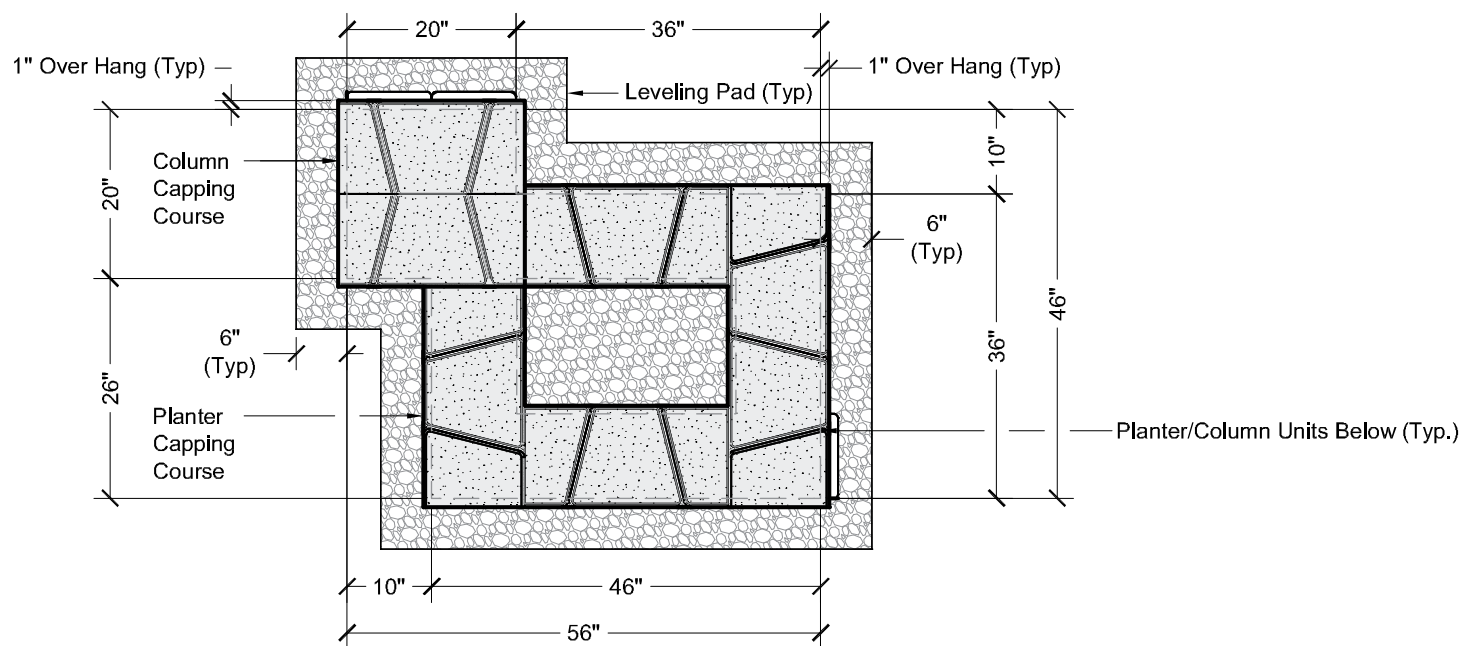

Planter w/Corner Column Plan

COURSE BY COURSE INSTRUCTIONS

1st Course Isometric

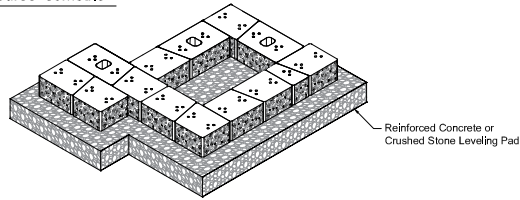

1st Course Plan

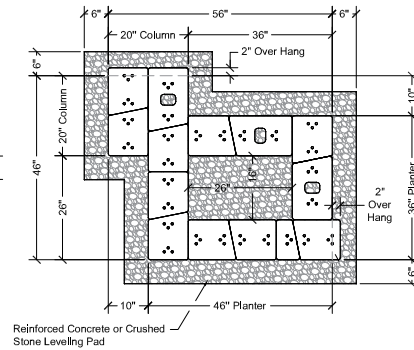

2nd Course Isometric

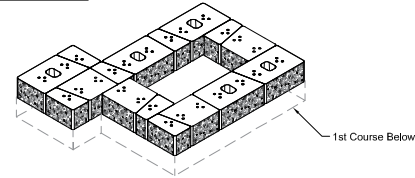

2nd Course Plan

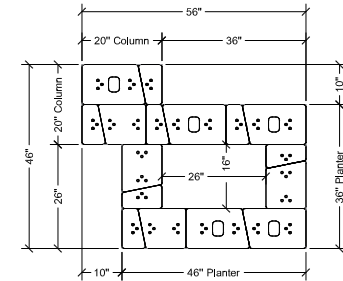

3rd Course Isometric

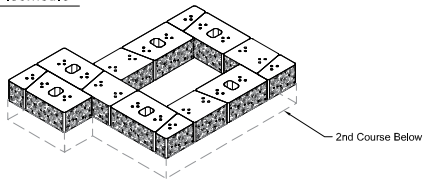

3rd Course Plan

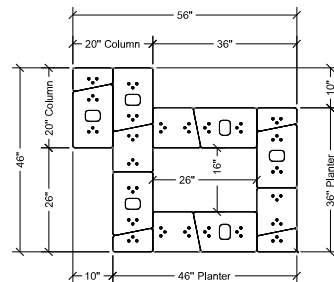

4th Course Isometric

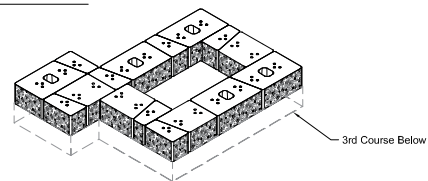

4th Course Plan

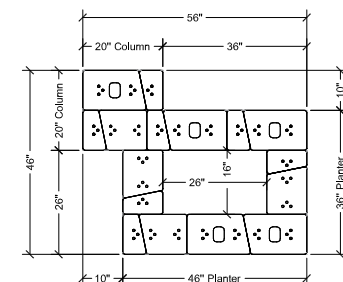

COURSE BY COURSE INSTRUCTIONS

4th Course Capping Isometric

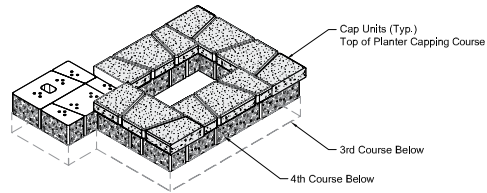

4th Course Capping Plan

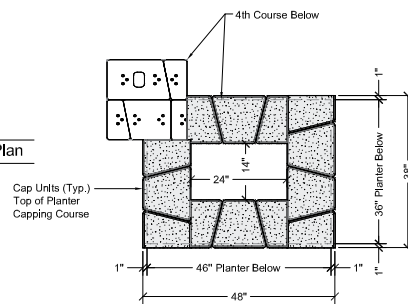

5th Course Isometric

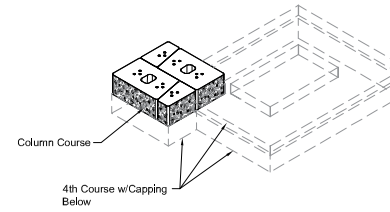

5th Course Plan

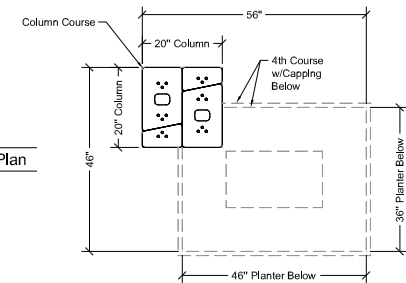

6th Course Isometric

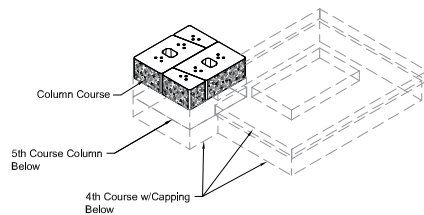

6th Course Plan

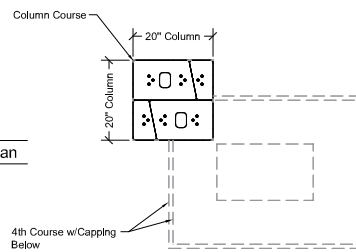

6th Course Capping Isometric

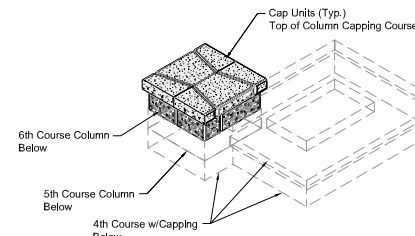

6th Course Capping Plan

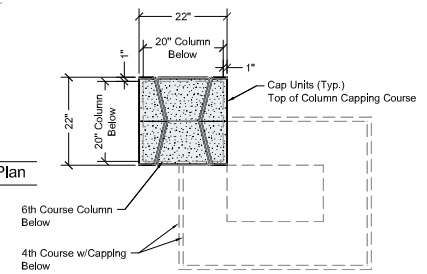

COURSE BY COURSE INSTRUCTIONS



Don't forget to check out all of our Keystone Outdoor Living designs on keystonewalls.com.



Outdoor Kitchen Designs



Fireplaces



Outdoor Table



Fire Pits



Water Feature



Bench



Keystone Retaining Wall Systems, LLC.
4444 West 78th Street • Minneapolis, MN 55435
(952) 897-1040 • www.keystonewalls.com



We reserve the right to improve our products and make changes in the specifications and design without notice. The information contained herein has been compiled by KEYSTONE and to the best of our knowledge, accurately represents the KEYSTONE product use in the applications which are illustrated. Final determination of the suitability for the use contemplated and its manner of use are the sole responsibility of the user.