

SECTION D

W A L L FINISHING O P T I O N S

A wall is not complete without the perfect finishing touch. The flexibility of the Keystone units creates a variety of wall finishing options. The most common wall finish is to cap the wall with a Keystone cap. Cap options vary by region so check with your local Keystone producer for availability in your area. Keystone units can also be capped with a variety of decorative precast concrete products, or even CIP concrete copings. This section outlines the construction techniques and details for these various options.

Tools and materials that will be required:

- 12 inch (305mm) and 48 inch (1.2m) levels
- Tape measure
- Personal protective equipment
- Keystone caps
- Landscape finishing material
- Exterior grade concrete adhesive

Cap Units: Introduction

A Keystone retaining wall is not complete until it is finished with the right cap. Keystone offers a selection of cap designs, available in various combinations of facial finish and degrees of angled sides*. The following information will clearly explain the uses of these units and show a variety of finishing techniques. You may also opt to finish your wall with a precast decorative concrete finishing option. See your local manufacturer for details.

CAPPING UNITS

Universal Cap: Finished on both front and back

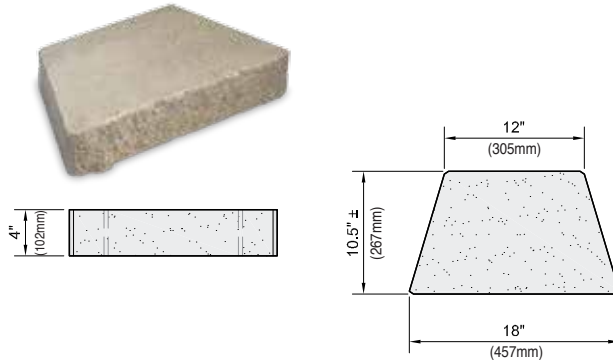

Straight-face: Straight-sided

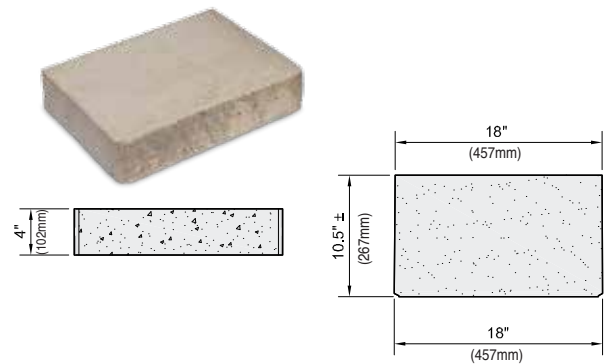

Tri-plane: Angle-sided

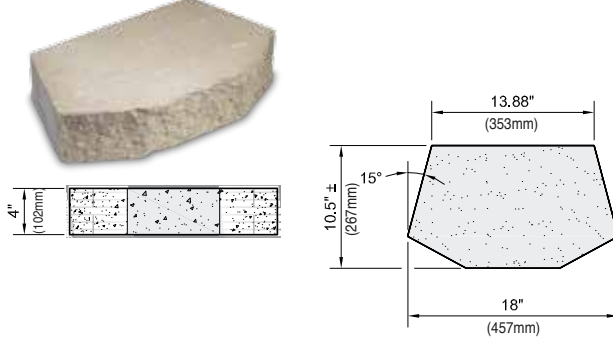

Tri-plane: Straight-sided

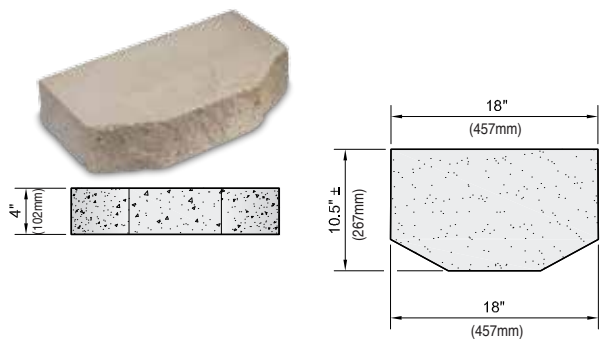
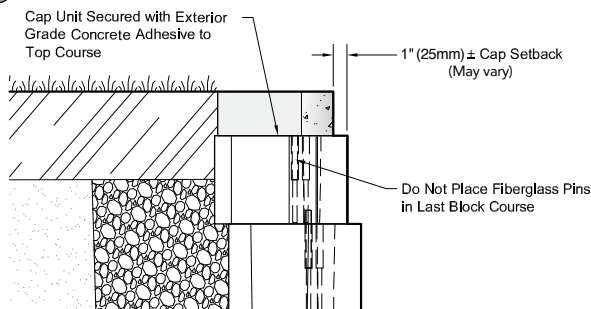
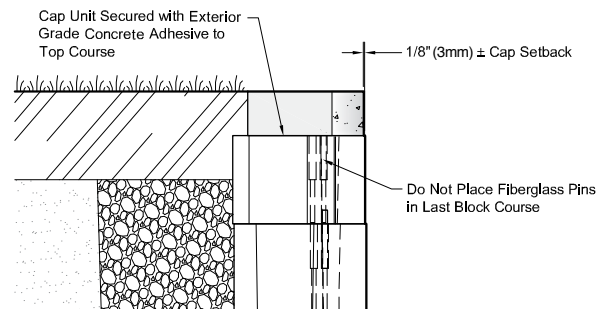

FIGURE D:1 - CAP SETBACK OPTIONS



Cap Setback - 1 Inch Setback Section



Cap Setback - Near Vertical Setback Section

NOTE:

*8" (203mm) capping option not shown. Capping options, weights, dimensions and product designs vary by manufacturer. Contact your local manufacturer for availability. Capping is not required to guarantee structural stability; capping improves the aesthetics of the finished wall.

The information contained herein has been compiled by Keystone Retaining Wall Systems® LLC and to the best of our knowledge, accurately represents the Keystone product use in the applications which are illustrated. Final determination of the suitability for the use contemplated and its manner of use are the sole responsibility of the user. Structural design and analysis shall be performed by a qualified engineer.

Like other Keystone units, all cap units can be used interchangeably. Depending on the wall contour, some cap units will work more effectively than others (i.e. angled side units for concave curves). In any given installation, if binding occurs between units, the units can be modified to fit using a concrete saw, chisel or other device. Make sure to wear proper PPE equipment when splitting or cutting.

Installation of the cap units is a simple one step operation. Sweep the lower units clean and make sure the units are dry; use a construction adhesive on the top surface of the last course before applying cap units. See Figure A:10 (p. 19) for installation instructions. The following illustrations demonstrate common uses of the Keystone cap units.

FIGURE D:2 - CONVEX CURVES - ANGLED SIDED CAPS

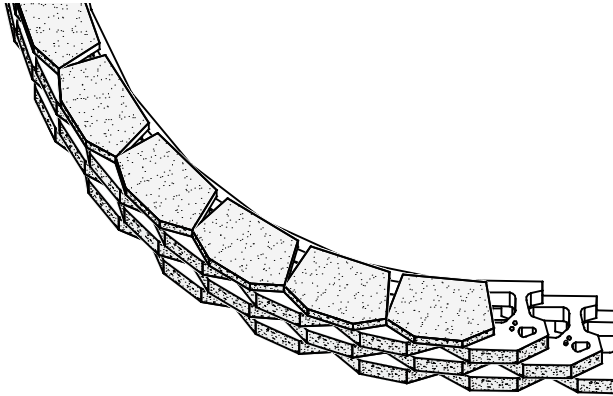

FIGURE D:3 - CONVEX CURVES - UNIVERSAL CAPS

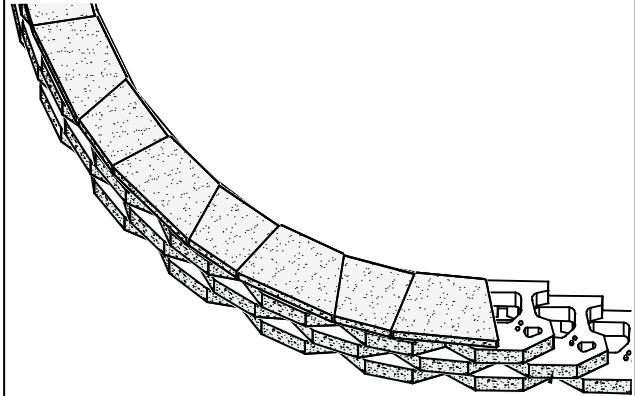

FIGURE D:4 - CONCAVE CURVES - ANGLED SIDED CAPS

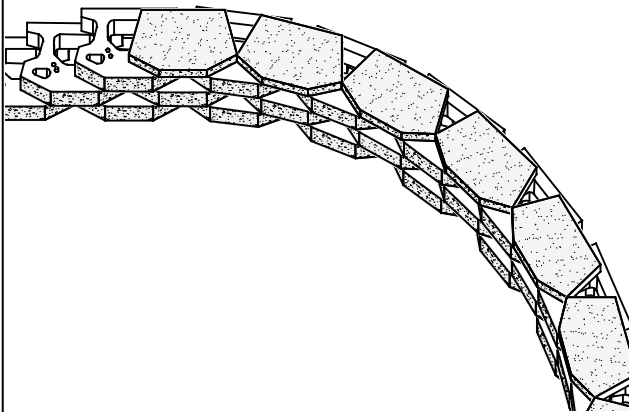

FIGURE D:5 - CONCAVE CURVES - UNIVERSAL CAPS

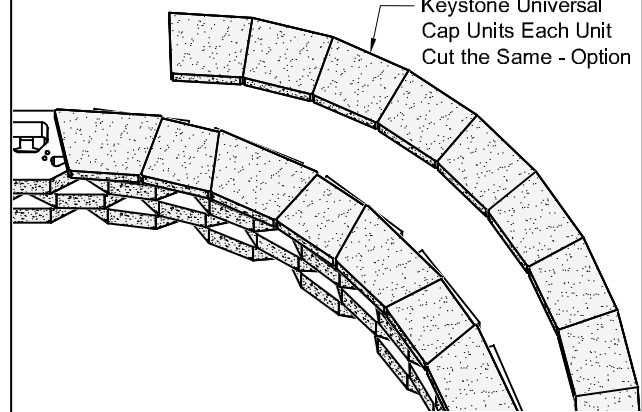
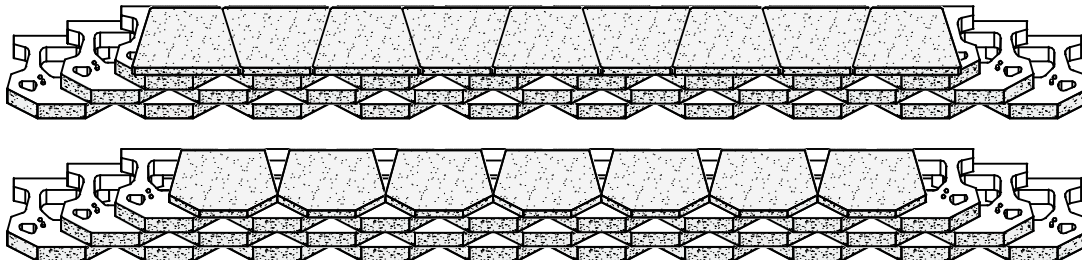

FIGURE D:6 - STRAIGHT WALL - UNIVERSAL CAPS AND TRI-PLANE ANGLE-SIDED CAPS



Capping: Installation

The size of each Keystone unit makes this system very adaptable to grade changes. The top of a Keystone wall can be constructed with level top of wall grade or up to 1:1 unit step-downs from the top of the wall. As the wall cap units step up and down grades, an additional installation procedure is required to firmly fix some cap units in position. To prevent showing the side of the wall units at the stepping of a wall, 4 inch (102mm) cap units can be double stacked or one 8 inch cap unit may be placed at each step down or step up location, see Figure A:3 (p. 14). The caps should be attached using a bonding material. Use a flexible epoxy-based adhesive designed to bond concrete or masonry. Refer to manufacturer's instructions for complete details. Apply the adhesive to areas where the units make contact. See Figure A:10 (p. 19) for installation instructions.

➤ FIGURE D:7 - STRAIGHT WALL WITH DOUBLE-STACKED CAP STEP

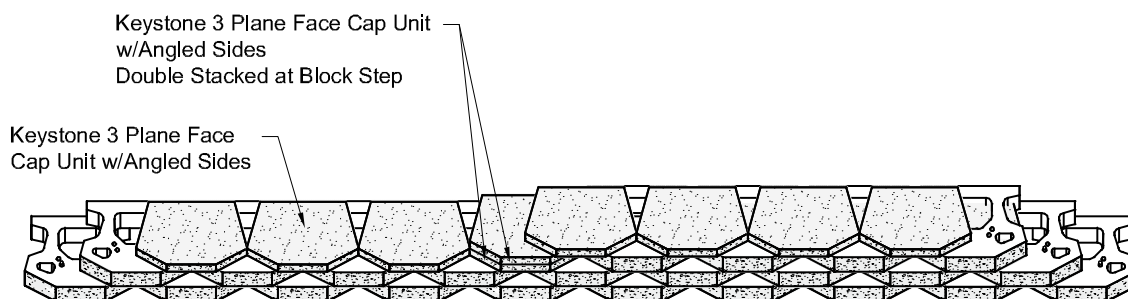

➤ FIGURE D:8 - RANDOM STEPS WITH SPLIT DOUBLE-STACKED UNIVERSAL CAPS

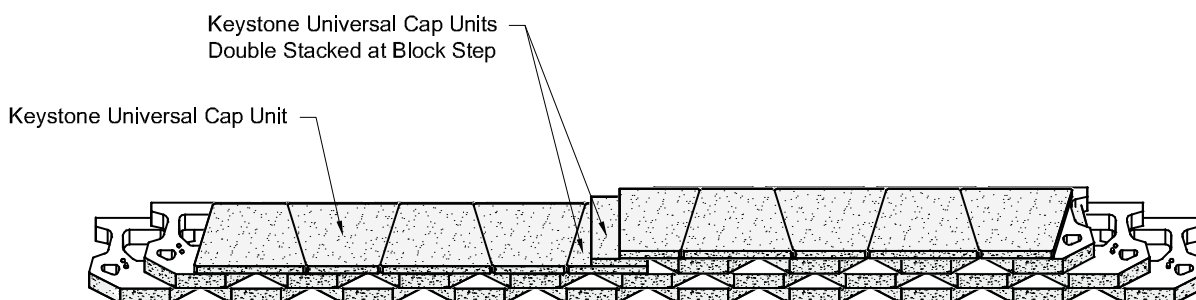

The information contained herein has been compiled by Keystone Retaining Wall Systems® LLC and to the best of our knowledge, accurately represents the Keystone product use in the applications which are illustrated. Final determination of the suitability for the use contemplated and its manner of use are the sole responsibility of the user. Structural design and analysis shall be performed by a qualified engineer.

 FIGURE D:9 - PARTIAL CAST IN PLACE CONCRETE COPING

